

Fig 7. 700SB Type engine shown

Table 3. Engine - As viewed on the crankshaft pulley (front) end

⇒ Fig 7. (D 10)

1	Rocker cover	9	Drive belt tensioner and pulley
2	Cylinder head	10	Coolant pump and drive pulley assembly
3	Cylinder block	11	Idler pulley
4	Bed plate	12	Alternator and drive pulley assembly
5	Lubrication oil pan (sump)	13	Cab heater water hose connector
6	Crankshaft pulley	14	Coolant temperature sender
7	Front end accessory drive belt	15	Coolant thermostat housing/radiator hose connector
8	Idler pulley		

### Engine Breather

#### Cleaning the Engine Breather Gauze

The breather gauze is located inside the rocker cover as shown at **12A**. It should be cleaned or changed at the recommended interval - [Service Schedules \(3-5\)](#).

- 1 Park the machine safe in accordance with the machine handbook instructions.
- 2 Remove the rocker cover, refer to **Rocker Cover, Section 12**.
- 3 Loosen and remove the filter gauze cover retaining screws **12B**.
- 4 Remove the filter gauze cover **12C** and the filters **12D**.
- 5 Using a suitable and safe cleaning solvent clean the filters (or fit new filters), make sure any residual oil has been fully removed.
- 6 Make sure the filters are fully dried before refitting.
- 7 Fit the gauze filters. Apply JCB Threadlocker to screws **12B**. Make sure that the tapped holes in the rocker cover are clean and free from excessive oil. Torque tighten the screws **12B** 8-10 Nm (6-7 lbf ft).

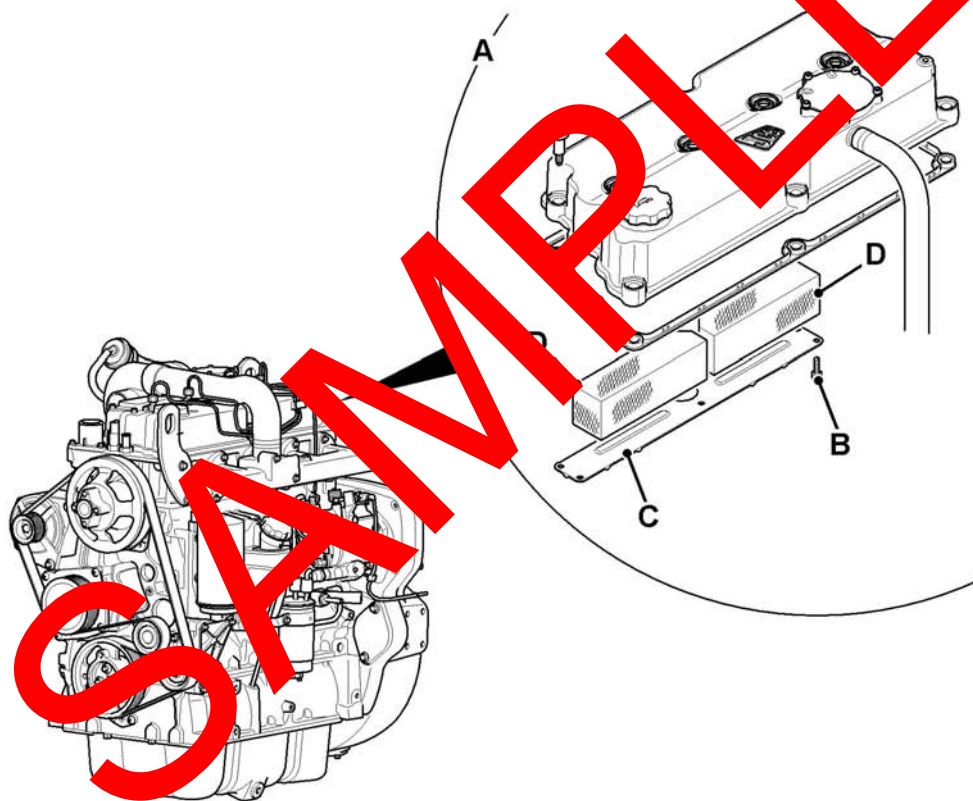

Fig 12.

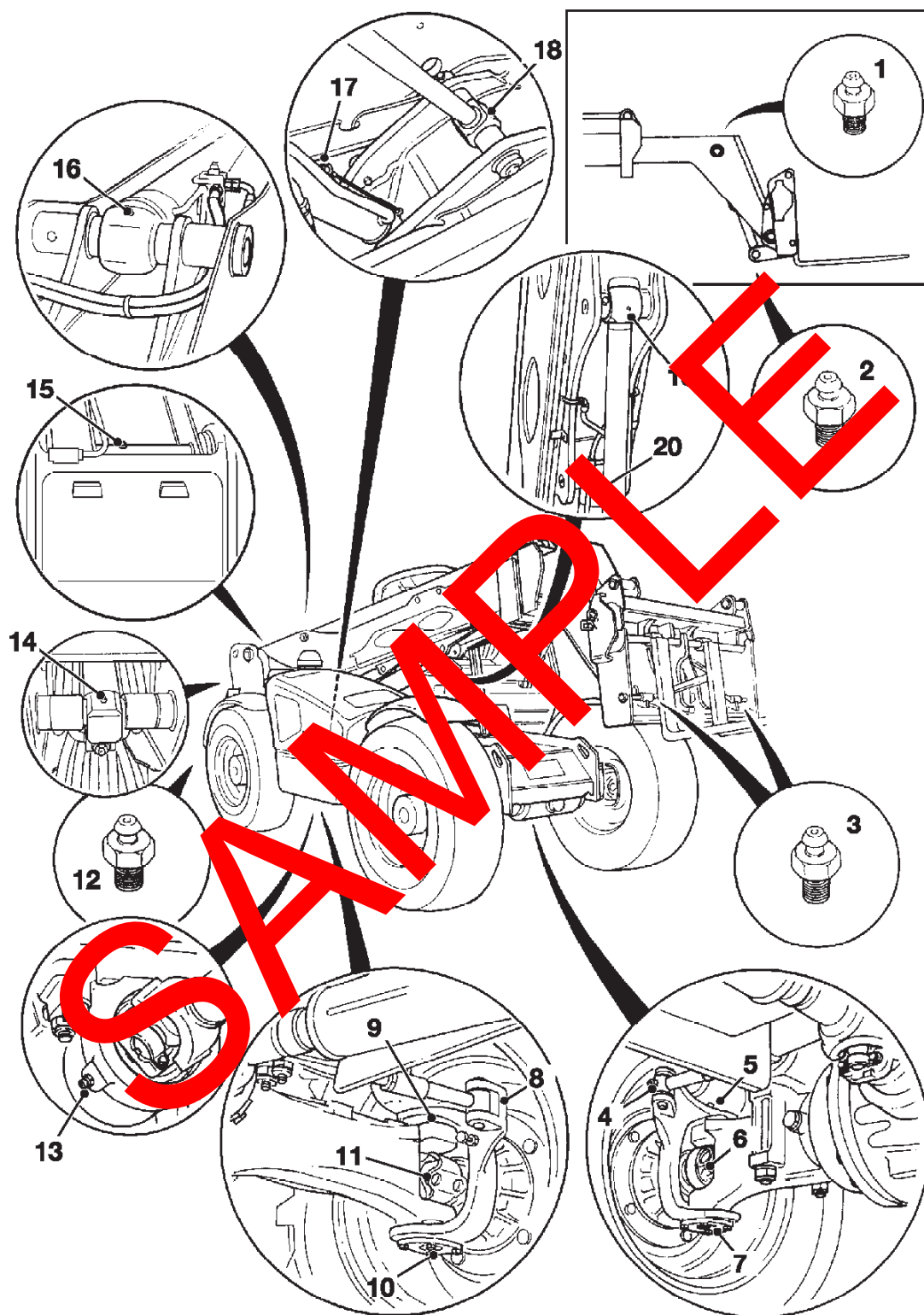

Fig 2. 533-105, 535-95

**Note:** 533-105: ➔ [Fig 3.](#) ([□ 3-10-5](#)).