

ENGINE (400 H.O.)

COOLING SYSTEM

Cooling System Specifications

The engine temperature switch is located in the engine cylinder head on the PTO side of the engine (see Chapter 9).

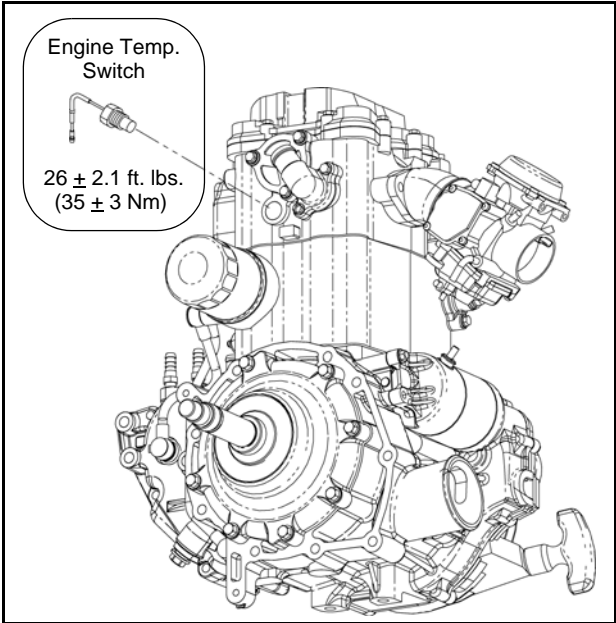

The fan switch (thermal switch) is located in the radiator on the left hand side (see Chapter 9 for further electrical information).

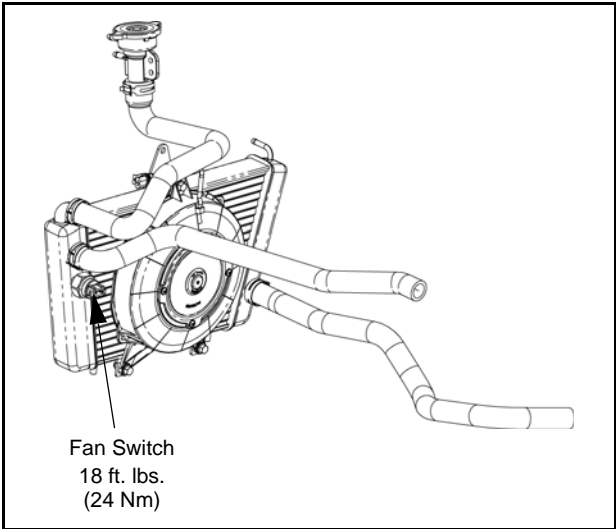

Item	Temperature / Specification
Thermostat	Opening Temperature 176° F (80° C) Closing Temperature 167° F (75° C) Open Over 3 mm @ 199° F (93° C)
System Capacity	2.25 Quarts (2.13L)
Radiator Cap Relief Pressure	13 PSI

Cooling System Layout and Testing

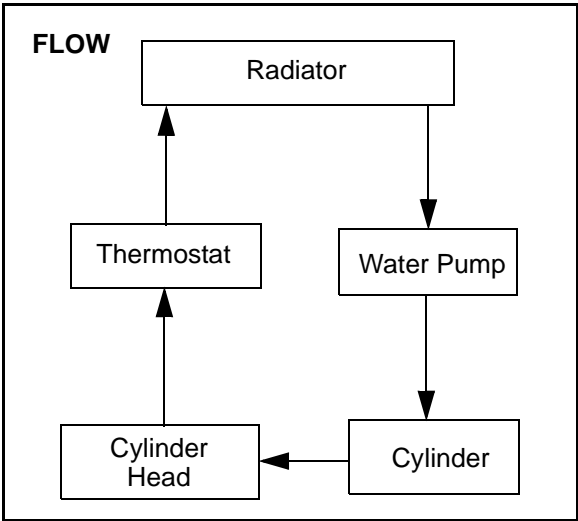

Cooling System Pressure Test

1. Lift up the front hood.

⚠ WARNING

Never remove radiator cap when engine is warm or hot. The cooling system is under pressure and serious burns may result. Allow the engine and cooling system to cool before servicing.

2. Remove the pressure cap from the radiator and pressure test the cooling system using a commercially available tester.
3. The system must retain 10 psi for five minutes or longer. If pressure loss is evident within five minutes, check radiator, all cooling system hoses and clamps and water pump seal for leakage.

Radiator Cap Pressure Test

⚠ WARNING

Never remove radiator cap when engine is warm or hot. The cooling system is under pressure and serious burns may result. Allow the engine and cooling system to cool before servicing.

1. Remove radiator pressure cap and test using a cap tester (commercially available).
2. The radiator cap relief pressure is 13 lbs. Replace cap if it does not meet this specification.

REAR BEARING CARRIER

Bearing Carrier Inspection

1. Support machine securely with rear wheels elevated.
2. Grasp wheel / hub and check for movement.
3. If movement is detected; inspect the hub, retaining nut torque and bearing condition. Correct as necessary.

CAUTION

Serious injury may result if machine tips or falls. Be sure machine is secure before beginning this service procedure. Wear eye protection when removing bearings and seals.

Bearing Carrier Removal

1. Place the ATV in neutral and lock the parking brake.
2. Remove the cotter pin from the wheel hub castle nut and loosen the hub nut slightly.
3. Loosen the wheel nuts, but do not remove.
4. Elevate rear end and safely support machine under main frame area.
5. Remove wheel nuts and wheel.
6. Remove the two brake caliper mounting bolts and remove the rear brake caliper (only if servicing the left-hand side).

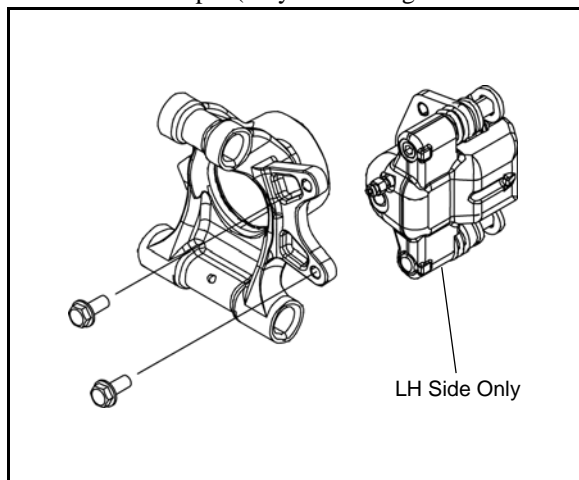

7. Safely suspend the caliper from the frame with a piece of wire. **CAUTION:** Do not hang the caliper by the brake line. Use wire to hang the caliper to prevent possible damage to the brake line.

8. Remove the wheel hub castle nut, washer, and remove the wheel hub from the rear drive shaft and rear bearing carrier.

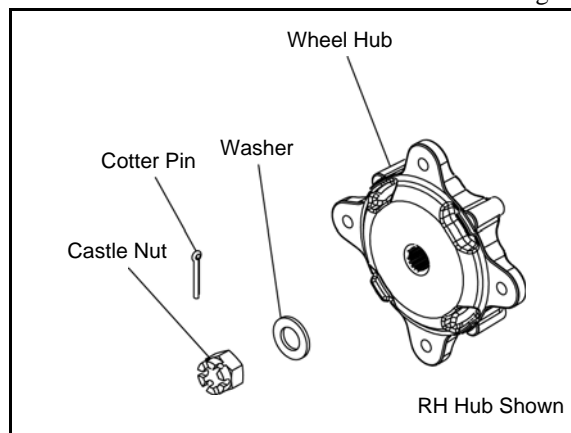

9. Remove the upper and lower control arm bolts from the rear bearing carrier.

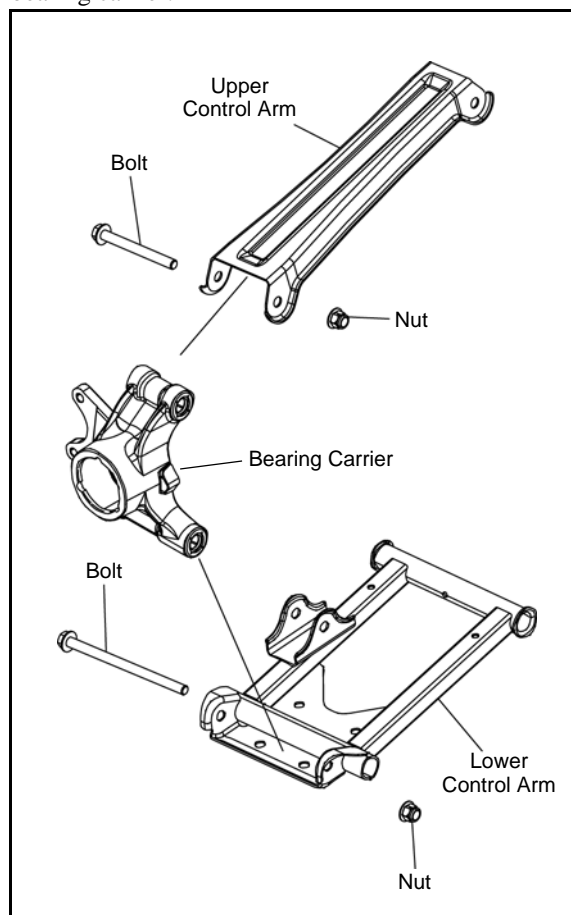

10. Remove the rear bearing carrier. Inspect the bearing for smoothness and side to side movement, replace as needed.