

L200

WORKSHOP MANUAL

FOREWORD

This Workshop Manual contains procedures for service mechanics, including removal, disassembly, inspection, adjustment, reassembly and installation. Use the following manuals in combination with this manual as required.

TECHNICAL INFORMATION MANUAL	PYTE9601
WORKSHOP MANUAL	
ENGINE GROUP	PWEE_____
	(Looseleaf edition)
ELECTRICAL WIRING	PHTE9601
BODY REPAIR MANUAL	PBTE9601
PARTS CATALOGUE	T603B006D

All information, illustrations and product descriptions contained in this manual are current as at the time of publication. We, however, reserve the right to make changes at any time without prior notice or obligation.



General	00
Engine	11
Engine Lubrication	12
Fuel	13
Engine Cooling	14
Intake and Exhaust	15
Engine Electrical	16
Engine and Emission Control	17
Clutch	21
Manual Transmission	22
Automatic Transmission	23
Propeller Shaft	25
Front Axle	26
Rear Axle	27
Wheel and Tyre	31
Power Plant Mount	32
Front Suspension	33
Rear Suspension	34
Service Brakes	35
Parking Brakes	36
Steering	37
Body	42
Exterior	51
Interior and Supplemental Restraint System (SRS)	52
Chassis Electrical	54
Heater, Air Conditioner and Ventilation	55

ENGINE

CONTENTS

11109000382

ENGINE <4G6>	11A
ENGINE <4D5>	11B

FUEL

CONTENTS

13109000924

MULTIPOINT FUEL INJECTION (MPI).....	13A
ELECTRONIC CONTROL TYPE CARBURETTOR.....	13B
CONVENTIONAL TYPE CARBURETTOR	13C
VARIABLE VENTURI TYPE CARBURETTOR.....	13D
DIESEL FUEL	13E
FUEL SUPPLY.....	13F
TRACTION CONTROL SYSTEM (TCL).....	13H
DIESEL FUEL <4D5-STEP III>	13I

NOTE
THE GROUPS MARKED BY  ARE NOT IN THIS MANUAL

SERVICE BRAKES

CONTENTS

35109000180

BASIC BRAKE SYSTEM 35A

ANTI-SKID BRAKING SYSTEM (ABS) <2WD> 35B

ANTI-SKID BRAKING SYSTEM (ABS) <4WD> 35C



INTERIOR AND SUPPLEMENTAL RESTRAINT SYSTEM (SRS)

CONTENTS

52109000187

INTERIOR	52A
SUPPLEMENTAL RESTRAINT SYSTEM (SRS)	52B



HEATER, AIR CONDITIONER AND VENTILATION

CONTENTS

HEATER, AIR CONDITIONER AND VENTILATION	55
AUTOMATIC AIR CONDITIONER	55B



GENERAL

GENERAL

CONTENTS

00109000423

HOW TO USE THIS MANUAL	2	VEHICLE IDENTIFICATION	16
Scope of Maintenance, Repair and Servicing		Vehicle Information Code Plate	16
Explanations	2	Models	17
Definition of Terms	2	Model Code	18
Indication of Tightening Torque	2	Chassis Number	19
Model Indications	3	Engine Model Number	20
Explanation of Manual Contents	4	MAJOR SPECIFICATIONS	21
HOW TO USE TROUBLESHOOTING/ INSPECTION SERVICE POINTS	6	PRECAUTIONS BEFORE SERVICE	25
Troubleshooting Contents	6	SUPPLEMENTAL RESTRAINT SYSTEM (SRS)	29
Diagnosis Function	7	SUPPORT LOCATIONS FOR LIFTING AND JACKING	32
How to Use the Inspection Procedures	9	Support Positions for a Garage Jack and Axle Stands	32
Connector Measurement Service Points	10	Support Positions for a Single-Post Lift or Double-Post Lift and H-BAR Lift	34
Connector Inspection	11	STANDARD PARTS-TIGHTENING-TORQUE TABLE	36
Inspection Service Points for a Blown Fuse ...	12		
Points to Note for Intermittent Malfunctions ...	12		
TREATMENT BEFORE/AFTER THE FORDING OF A STREAM (4WD VEHICLES)	13		
Inspection and Service before Fording a Stream	13		
Inspection and Service after Fording a Stream	15		

HOW TO USE THIS MANUAL

SCOPE OF MAINTENANCE, REPAIR AND SERVICING EXPLANATIONS

This manual provides explanations, etc. concerning procedures for the inspection, maintenance, repair and servicing of the subject model. Note, however, that for engine and transmission-related component parts, this manual covers only on-vehicle inspections, adjustments, and the removal and installation procedures for major components.

For detailed information concerning the inspection, checking, adjustment, disassembly and reassembly of the engine, transmission and major components after they have been removed from the vehicle, please refer to separate manuals covering the engine and the transmission.

ON-VEHICLE SERVICE

“On-vehicle Service” is procedures for performing inspections and adjustments of particularly important locations with regard to the construction and for maintenance and servicing, but other inspection (for looseness, play, cracking, damage, etc.) must also be performed.

INSPECTION

Under this title are presented inspection and checking procedures to be performed by using special tools and measuring instruments and by feeling, but, for actual maintenance and servicing procedures, visual inspections should always be performed as well.

DEFINITION OF TERMS

STANDARD VALUE

Indicates the value used as the standard for judging the quality of a part or assembly on inspection or the value to which the part or assembly is corrected and adjusted. It is given by tolerance.

LIMIT

Shows the standard for judging the quality of a part or assembly on inspection and means the maximum or minimum value within which the part or assembly must be kept functionally or in strength. It is a value established outside the range of standard value.

REFERENCE VALUE

Indicates the adjustment value prior to starting the work (presented in order to facilitate assembly and adjustment procedures, and so they can be completed in a shorter time).

CAUTION

Indicates the presentation of information particularly vital to the worker during the performance of maintenance and servicing procedures in order to avoid the possibility of injury to the worker, or damage to component parts, or a reduction of component or vehicle function or performance, etc.

INDICATION OF TIGHTENING TORQUE

The tightening torque shown in this manual is a basic value with a tolerance of $\pm 10\%$ except the following cases when the upper and lower limits of tightening torque are given.

- (1) The tolerance of the basic value is within $\pm 10\%$.
- (2) Special bolts or the like are in use.
- (3) Special tightening methods are used.

MODEL INDICATIONS

The following abbreviations are used in this manual for classification of model types.

M/T:	Indicates the manual transmission, or models equipped with the manual transmission.
A/T:	Indicates the automatic transmission, or models equipped with the automatic transmission.
SOHC:	Indicates an engine with the single overhead camshaft, or a model equipped with such an engine.
MPI:	Indicates the multi-point injection, or engines equipped with the multi-point injection.
DIESEL:	Indicates a diesel engine, or models equipped with such an engine.
2WD:	Indicates the rear wheel-drive vehicles.
4WD:	Indicates the 4 wheel-drive vehicles.

EXPLANATION OF MANUAL CONTENTS

Indicates procedures to be performed before the work in that section is started, and procedures to be performed after the work in that section is finished.

Component Diagram
A diagram of the component parts is provided near the front of each section in order to give a reader a better understanding of the installed condition of component parts.

Indicates (by symbols) where lubrication is necessary.

Maintenance and Servicing Procedures
The numbers provided within the diagram indicate the sequence for maintenance and servicing procedures.

- Removal steps:
The part designation number corresponds to the number in the illustration to indicate removal steps.
- Disassembly steps:
The part designation number corresponds to the number in the illustration to indicate disassembly steps.

- Installation steps:
Specified in case installation is impossible in reverse order of removal steps. Omitted if installation is possible in reverse order of removal steps.
- Reassembly steps:
Specified in case reassembly is impossible in reverse order of disassembly steps. Omitted if reassembly is possible in reverse order of disassembly steps.





Classifications of Major Maintenance/Service Points
When there are major points relative to maintenance and servicing procedures (such as essential maintenance and service points, maintenance and service standard values, information regarding the use of special tools, etc.), these are arranged together as major maintenance and service points and explained in detail.

 : Indicates that there are essential points for removal or disassembly.

 : Indicates that there are essential points for installation or reassembly.

Symbols for Lubrication, Sealants and Adhesives

Information concerning the locations for lubrication and for application of sealants and adhesives is provided, by using symbols, in the diagram of component parts or on the page following the component parts page, and explained.

-  : Grease
(multipurpose grease unless there is a brand or type specified)
-  : Sealant or adhesive
-  : Brake fluid or automatic transmission fluid
-  : Engine oil, gear oil or air conditioner compressor oil
-  : Adhesive tape or butyl rubber tape

Indicates the
group title.Indicates the
section title.Indicates the
group num-
ber.Indicates the
page number.

STEERING – Power Steering Oil Pump

37A-29

POWER STEERING GEAR BOX

120000039

REMOVAL AND INSTALLATION

Pre-removal Operation

- (1) Power Steering Fluid Draining (Refer to P. 37A-10.)
- (2) Air Cleaner Assembly Removal
- (3) Under Cover Removal (Refer to GROUP 42 – Under Cover.)

<2WD>

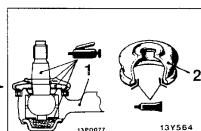
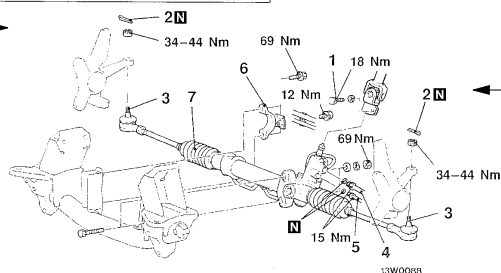

Sealant: 3M ATD Part No.
8661 or equivalent

Removal steps

1. Lower shaft assembly and gear box connecting bolt
2. Split pin
3. Connection for tie-rod end and knuckle
4. Connection for return tube

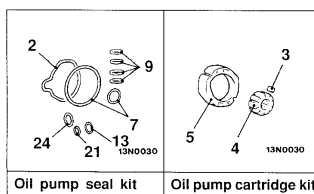

5. Connection for pressure tube
6. Clamp
7. Gear box assembly

Denotes non-reus-
able part.

Denotes tightening torque.
For bolts and nuts which do not
have a tightening torque listed,
refer to the "Standard Parts-
tightening-torque Table".

Repair kit or set parts
are shown. (Only very
frequently used parts
are shown.)

REMOVAL SERVICE POINTS

<A> TIE-ROD END DISCONNECTION

Caution

1. Using the special tool, loosen the tie rod end mounting nut. Only loosen the nut; do not remove it from the ball joint.
2. Support the special tool with a cord, etc. to prevent it from coming off.

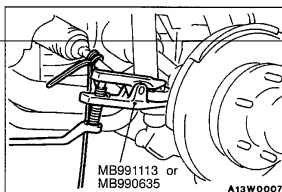

Operating procedures, cau-
tions, etc. on removal, installa-
tion, disassembly and reas-
sembly are described.

HEADLAMP RELAY CONTINUITY INSPECTION

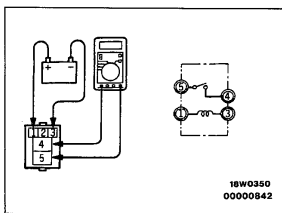

Battery voltage	Terminal No.			
	1	3	4	5
Power is not supplied	○	○	○	○
Power is supplied	⊕	⊖	○	○

○—○ indicates that there is
a continuity between the termi-
nals.

⊕—⊖ indicates terminals to
which battery voltage is applied.

35A-26 BASIC BRAKE SYSTEM – Master Cylinder and Brake Booster

Lubrication and sealing points

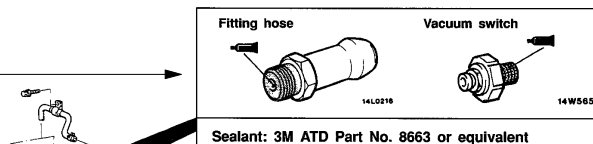

Sealant: 3M ATD Part No. 8663 or equivalent

The title of the page (following
the page on which the diagram
of component parts is pres-
ented) indicating the locations of
lubrication and sealing proce-
dures.

00002471

HOW TO USE TROUBLESHOOTING/INSPECTION SERVICE POINTS

00100020091

Troubleshooting of electronic control systems for which the MUT-II can be used follows the basic outline described below. Furthermore, even in systems for which the MUT-II cannot be used, part of these systems still follow this outline.

TROUBLESHOOTING CONTENTS

1. STANDARD FLOW OF DIAGNOSIS TROUBLESHOOTING

The troubleshooting sections follow the basic diagnosis flow which is given below. If the diagnosis flow is different from that given below, or if additional explanation is required, the details of such differences or additions will also be listed.

Diagnosis method

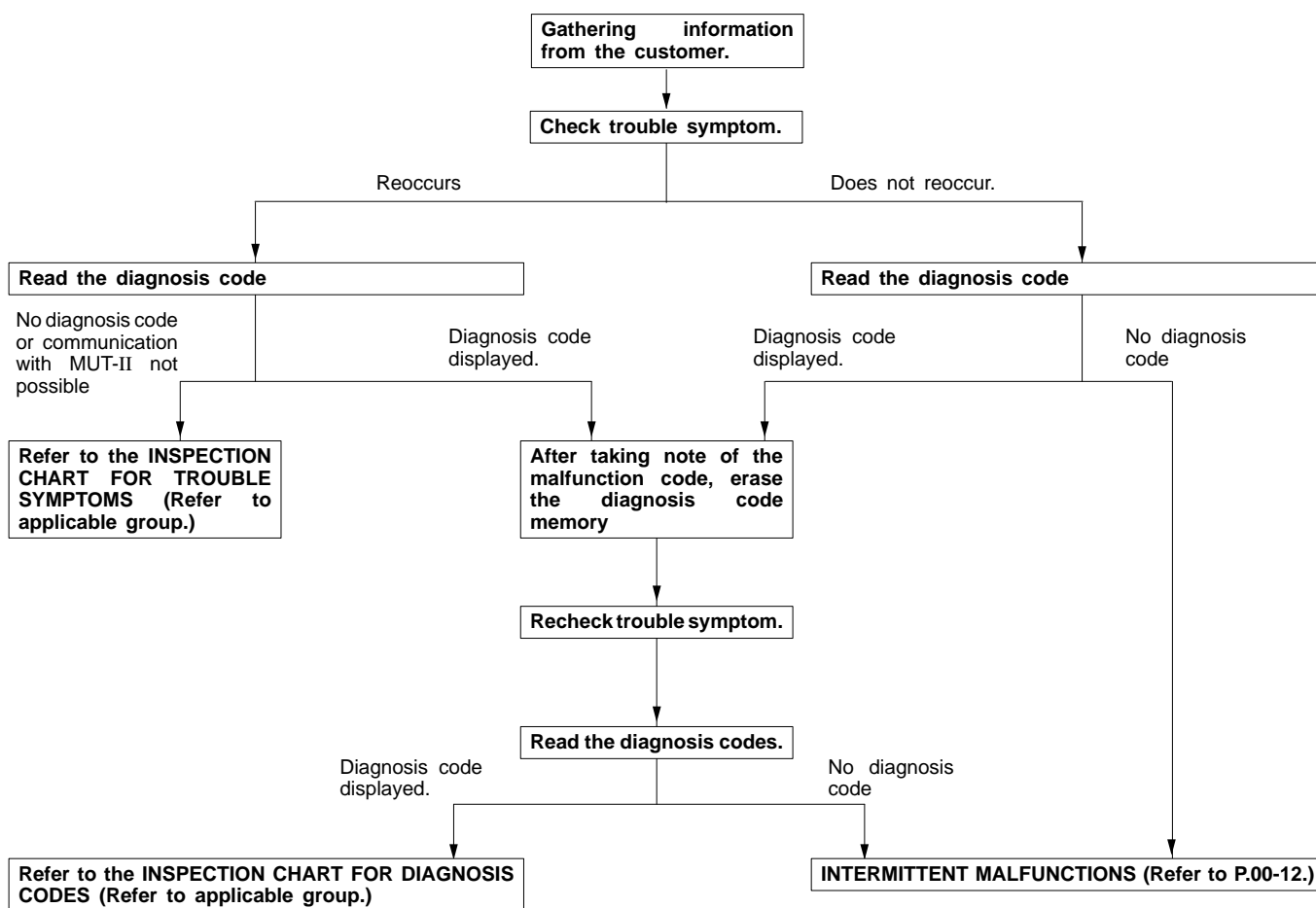

2. SYSTEM OPERATION AND SYMPTOM VERIFICATION TESTS

If verification of the trouble symptoms is difficult, procedures for checking operation and verifying trouble symptoms are shown.

3. DIAGNOSIS FUNCTION

Details which are different from those in the "Diagnosis Function" section on the next page are listed.

4. INSPECTION CHART FOR DIAGNOSIS CODES**5. INSPECTION PROCEDURE FOR DIAGNOSIS CODES**

Indicates the inspection procedures corresponding to each diagnosis code. (Refer to P.00-9 for how to read the inspection procedures.)

6. INSPECTION CHART FOR TROUBLE SYMPTOMS

If there are trouble symptoms even though the results of inspection using the MUT-II show that all diagnosis codes are normal, inspection procedures for each trouble symptom will be found by means of this chart.

7. INSPECTION PROCEDURE FOR TROUBLE SYMPTOM

Indicates the inspection procedures corresponding to each trouble symptoms classified in the Inspection Chart for Trouble Symptoms. (Refer to P.00-9 for how to read the inspection procedures.)

8. SERVICE DATA REFERENCE TABLE

Inspection items and normal judgement values have been provided in this chart as reference information.

9. CHECK AT ECU TERMINALS

Terminal numbers for the ECU connectors, inspection items and standard values have been provided in this chart as reference information.

10. INSPECTION PROCEDURES USING AN OSCILLOSCOPE

When there are inspection procedures using an oscilloscope, these are listed here.

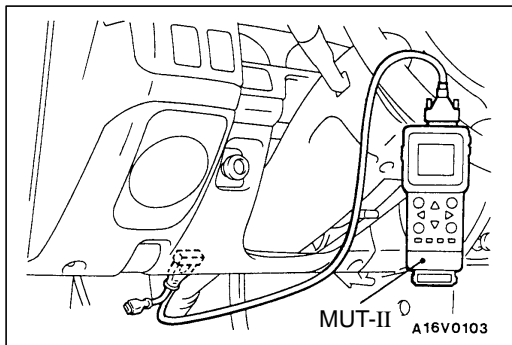
**DIAGNOSIS FUNCTION****METHOD OF READING DIAGNOSIS CODES
WHEN USING THE MUT-II**

Connect the MUT-II to the diagnosis connector and take a reading of the diagnosis codes.

Caution

Turn off the ignition switch before connecting or disconnecting the MUT-II.

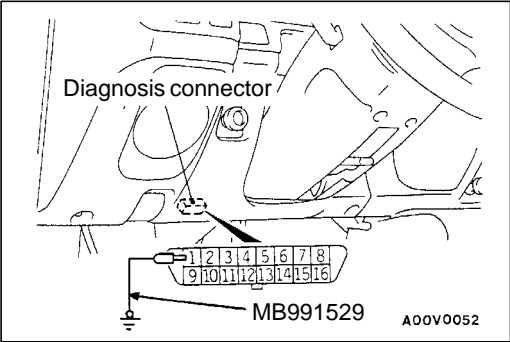

WHEN USING THE WARNING LAMP

- 1. Use the special tool to earth No.1 terminal (diagnosis control terminal) of the diagnosis connector.
- 2. To check ABS system, remove the valve relay.

NOTE

That is because the valve relay is off and the warning lamp remains illuminated if there is a fault in the ABS system.

- 3. Turn off the ignition switch.
- 4. Read out a diagnosis code by observing how the warning lamp flashes.

Applicable systems

System name	Warning lamp name
MPI	Engine warning lamp
ABS	ABS warning lamp

Indication of diagnosis code by warning lamp

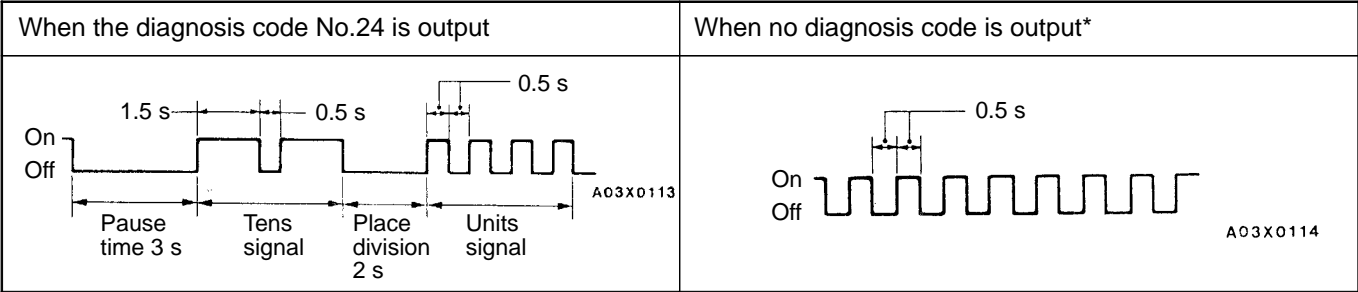

NOTE

*: Even if the ABS system is normal, removing the valve relay causes the diagnosis code No.51 to be output.

METHOD OF ERASING DIAGNOSIS CODES

WHEN USING THE MUT-II

Connect the MUT-II to the diagnosis connector and erase the diagnosis code.

Caution

Turn off the ignition switch before connecting or disconnecting the MUT-II.

WHEN NOT USING THE MUT-II

- (1) Turn the ignition switch to OFF.
- (2) After disconnecting the battery cable from the battery (–) terminal for 10 seconds or more, reconnect the cable.
- (3) After the engine has warmed up, run it at idle for about 15 minutes.

HOW TO USE THE INSPECTION PROCEDURES

The causes of a high frequency of problems occurring in electronic circuitry are generally the connectors, components, the ECU and the harnesses between connectors, in that order. These inspection procedures follow this order, and they first try to discover a problem with a connector or a defective component.

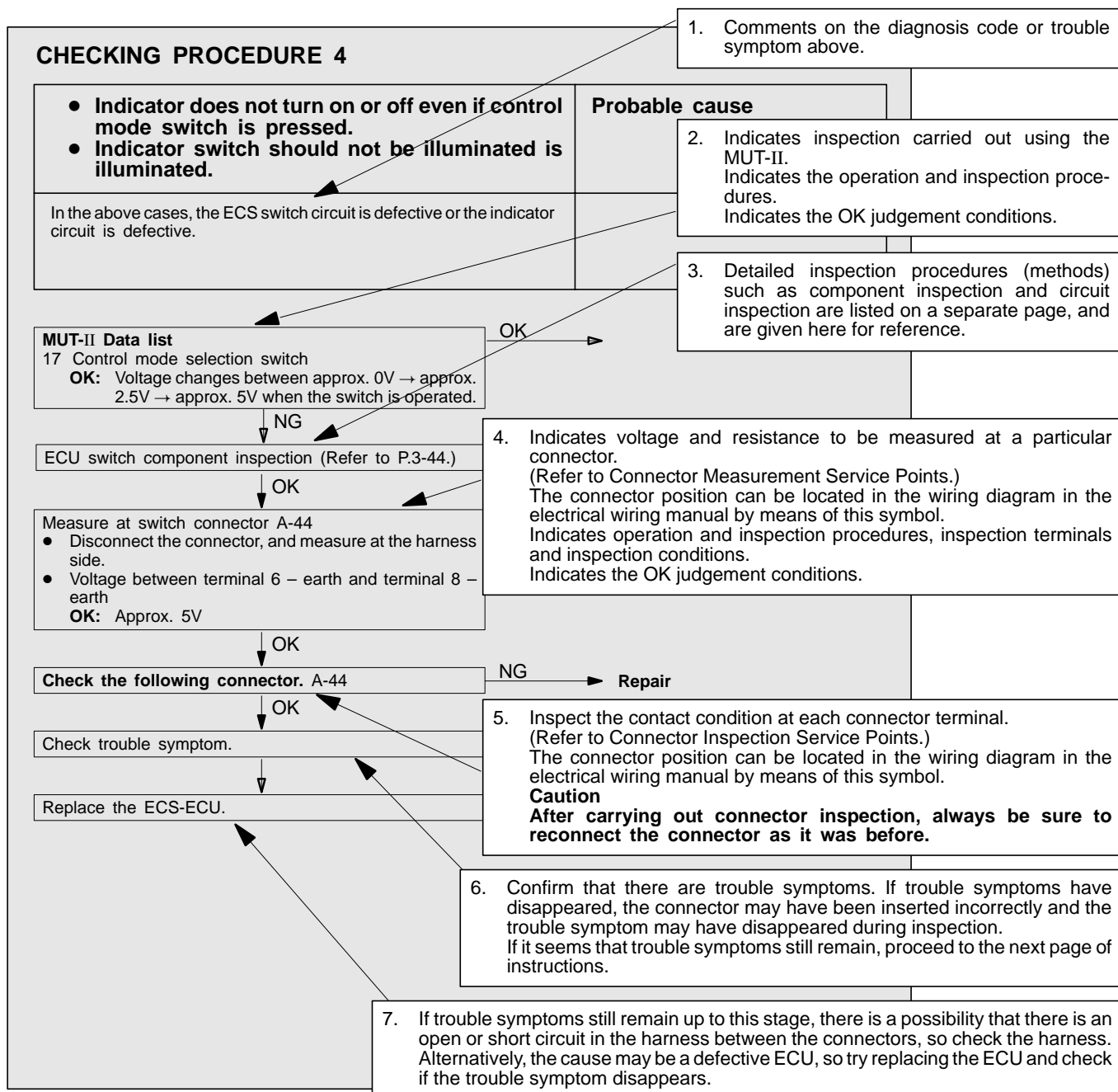

HARNESS INSPECTION

Check for an open or short circuit in the harness between the terminals which were defective according to the connector measurements. Carry out this inspection while referring to the electrical wiring manual. Here, "Check harness between power supply and terminal xx" also includes checking for blown fuses. For inspection service points when there is a blown fuse, refer to "Inspection Service Points for a Blown Fuse."

MEASURES TO TAKE AFTER REPLACING THE ECU

If the trouble symptoms have not disappeared even after replacing the ECU, repeat the inspection procedure from the beginning.

CONNECTOR MEASUREMENT SERVICE POINTS

Turn the ignition switch to OFF when connecting/disconnecting the connectors, and turn the ignition switch to ON when measuring if there are no instructions to be contrary.

IF INSPECTING WITH THE CONNECTOR CONNECTED (WITH CIRCUIT IN A CONDITION OF CONTINUITY)

Waterproof Connectors

Be sure to use the special tool (harness connector). Never insert a test bar from the harness side, because to do so will reduce the waterproof performance and result in corrosion.

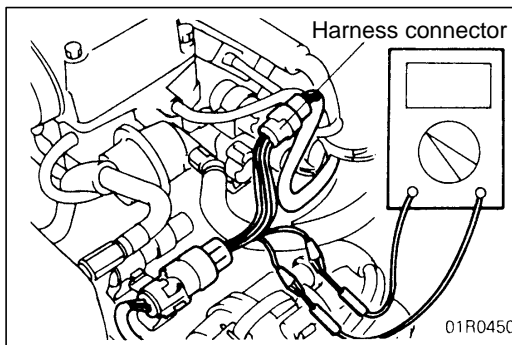

Ordinary (non-waterproof) Connectors

Check by inserting the test bar from the harness side. Note that if the connector (control unit, etc.) is too small to permit insertion of the test bar, it should not be forced; use a special tool (the extra-thin probe in the harness set for checking for this purpose).

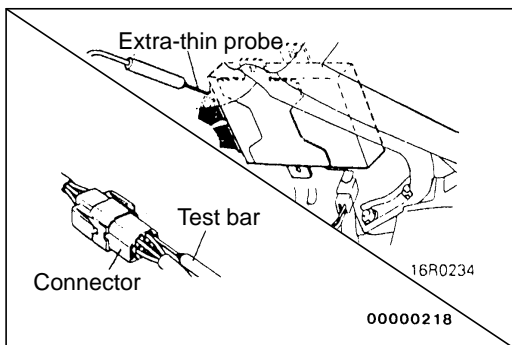

IF INSPECTING WITH THE CONNECTOR DISCONNECTED

<When Inspecting a Female Pin>

Use the special tool (inspection harness for connector pin contact pressure in the harness set for inspection). The inspection harness for connector pin contact pressure should be used. The test bar should never be forcibly inserted, as it may cause a defective contact.

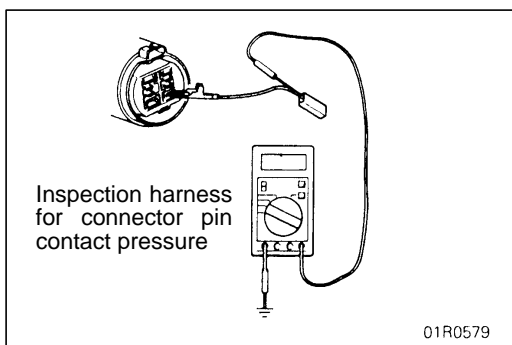

<When Inspecting a Male Pin>

Touch the pin directly with the test bar.

Caution

At this time, be careful not to short the connector pins with the test bars. To do so may damage the circuits inside the ECU.

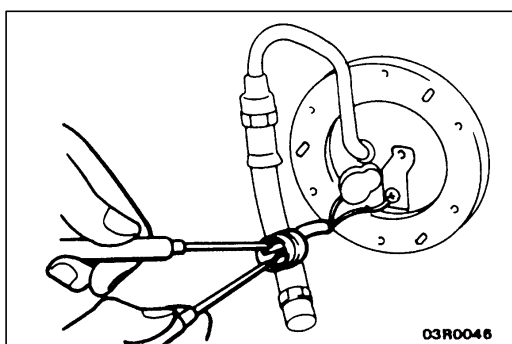

Connector disconnected or improperly connected

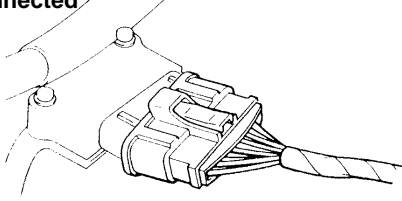

16S0256

Defective connector contact

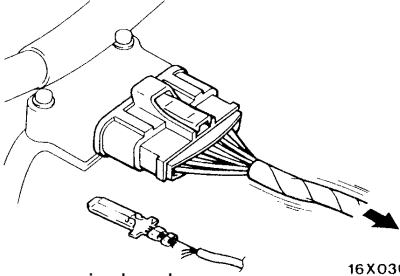

Harness wire breakage at terminal section

16X0369

Low contact pressure

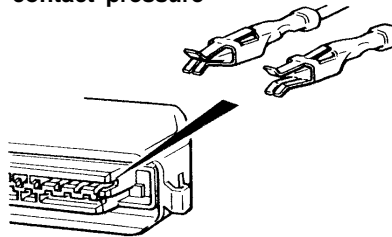

16S0254
00000219

CONNECTOR INSPECTION

VISUAL INSPECTION

- Connector is disconnected or improperly connected
- Connector pins are pulled out
- Due to harness tension at terminal section
- Low contact pressure between male and female terminals
- Low connection pressure due to rusted terminals or foreign matter lodged in terminals

CONNECTOR PIN INSPECTION

If the connector pin stopper is damaged, the terminal connections (male and female pins) will not be perfect even if the connector body is connected, and the pins may pull out of the reverse side of the connector. Therefore, gently pull the harnesses one by one to make sure that no pins pull out of the connector.

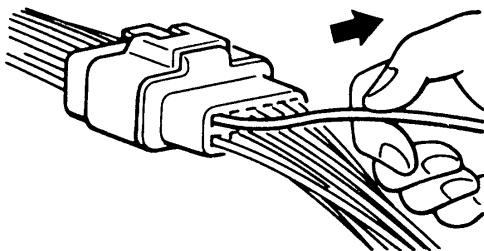

16R1317

CONNECTOR ENGAGEMENT INSPECTION

Use the special tool (connector pin connection pressure inspection harness of the inspection harness set) to inspect the engagement of the male pins and females pins. (Pin drawing force : 1 N or more)

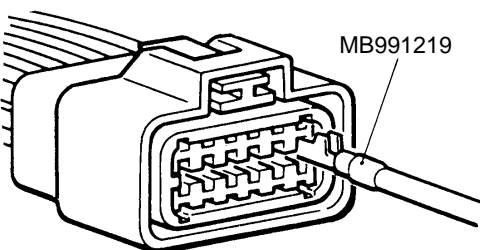

16R1318

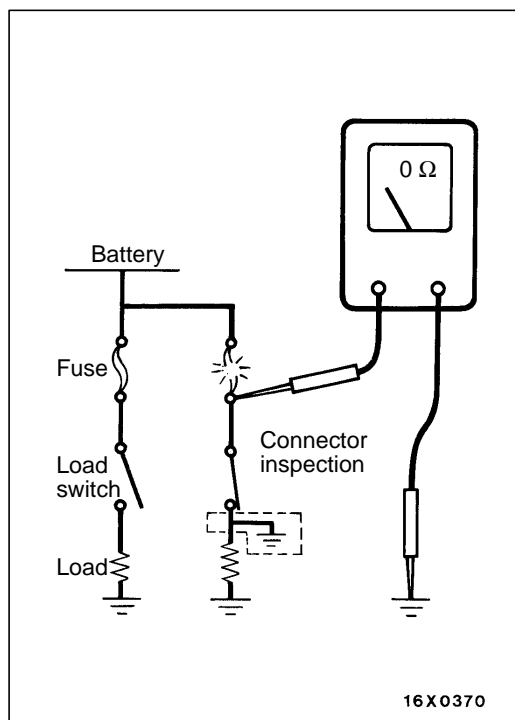

INSPECTION SERVICE POINTS FOR A BLOWN FUSE

Remove the fuse and measure the resistance between the load side of the fuse and the earth. Set the switches of all circuits which are connected to this fuse to a condition of continuity. If the resistance is almost 0 Ω at this time, there is a short somewhere between these switches and the load. If the resistance is not 0 Ω, there is no short at the present time, but a momentary short has probably caused the fuse to blow.

The main causes of a short circuit are the following.

- Harness being clamped by the vehicle body
- Damage to the outer casing of the harness due to wear or heat
- Water getting into the connector or circuitry
- Human error (mistakenly shorting a circuit, etc.)

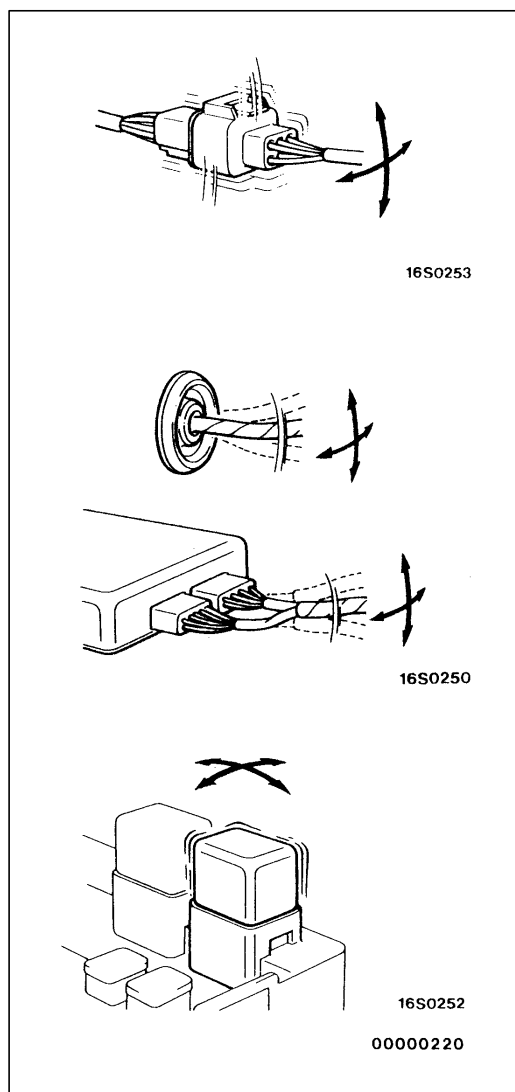

POINTS TO NOTE FOR INTERMITTENT MALFUNCTIONS

Intermittent malfunctions often occur under certain conditions, and if these conditions can be ascertained, determining the cause becomes simple. In order to ascertain the conditions under which an intermittent malfunction occurs, first ask the customer for details about the driving conditions, weather conditions, frequency of occurrence and trouble symptoms, and then try to recreate the trouble symptoms. Next, ascertain whether the reason why the trouble symptom occurred under these conditions is due to vibration, temperature or some other factor. If vibration is thought to be the cause, carry out the following checks with the connectors and components to confirm whether the trouble symptom occurs.

The objects to be checked are connectors and components which are indicated by inspection procedures or given as probable causes (which generates diagnosis codes or trouble symptoms.)

- Gently shake the connector up, down and to the left and right.
- Gently shake the wiring harness up, down and to the left and right.
- Gently rock each sensor and relay, etc. by hand.
- Gently shake the wiring harness at suspensions and other moving parts.

NOTE

If determining the cause is difficult, the flight recorder function of the MUT-II can also be used.

TREATMENT BEFORE/AFTER THE FORDING OF A STREAM (4WD VEHICLES)

00100060031

INSPECTION AND SERVICE BEFORE FORDING A STREAM

Vehicles which are driven through water, or which may possibly be driven through water, should be subjected to the following inspections and maintenance procedures in advance.

- Seal the speedometer cable with a water-resistant grease or tape.
- Inspect the dust boots and breather hose for cracks or damage, and replace them if cracks or damage are found.

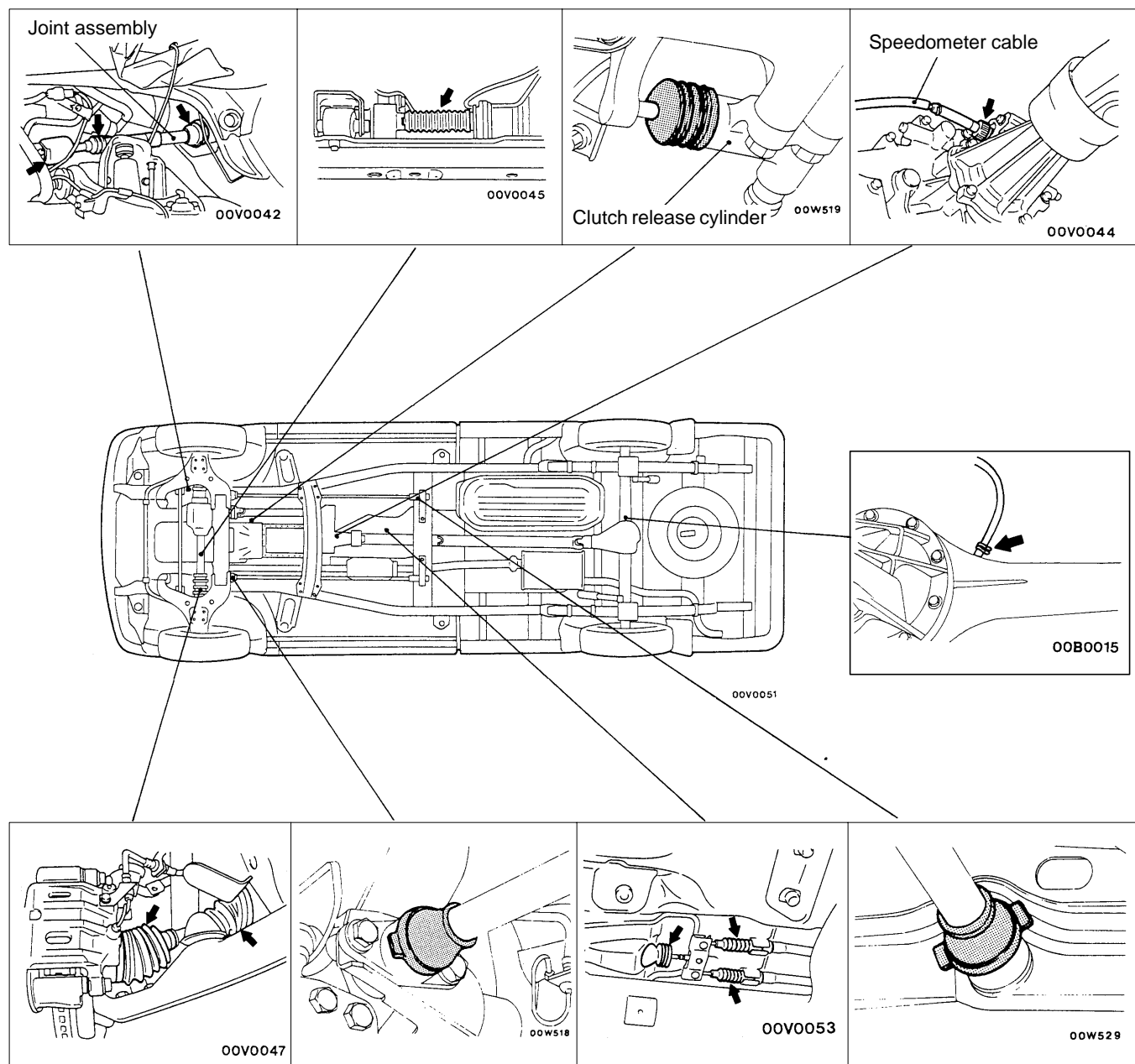

00004965